

# FREQUENTLY ASKED QUESTIONS

Updated as of July 03, 2023

<b>ACADEMICS:</b>	<b>3</b>
What is the building layout and where are the fire exits?	3
How do I know my assigned classroom and schedule?	4
Where do I get my Certificate of Registration?	4
What should I know about examinations?	4
When is my instructor available for consultation?	4
Who are the heads of the various programs?	5
Is there an evaluation process for my instructors?	5
When is the period for examinations?	5
First Semester	5
Second Semester	5
<b>REGISTRAR:</b>	<b>6</b>
First Semester	6
When is enrollment?	6
When is adding and dropping?	6
When is the start of class?	6
Second Semester	6
When is enrollment?	6
When is adding and dropping?	6
When is the start of class?	6
How do I check my grades and account balance?	7
How do I apply for graduation?	7
What is AISAT's Data Privacy Policy?	7
<b>CASHIER:</b>	<b>7</b>
First Semester Fees	8
Second Semester Fees	10
When is my balance payable?	12
First Semester	12
Second Semester	12
How do I compute my payables?	12
How do I pay for my fees?	13
How do I inform the school of my payments?	13
What is the cost of Uniforms?	14
What is included in the Type A sets?	15
How do I check my account balance and grades?	16
Will I be able to enroll if I have a pending balance from the previous semester?	16

<b>OSA:</b>	<b>17</b>
When will the orientation be?	17
First Semester	17
Second Semester	17
What scholarships are available?	17
What information can I find on the AISAT website?	18
How are school announcements made?	18
<b>FORMS:</b>	<b>19</b>
Order Forms	19
Request Forms	19
May I send someone to claim my requested item(s)?	20
<b>CONTACT DETAILS:</b>	<b>21</b>
Who can I go to for various concerns?	21

# ACADEMICS:

What is the building layout and where are the fire exits?

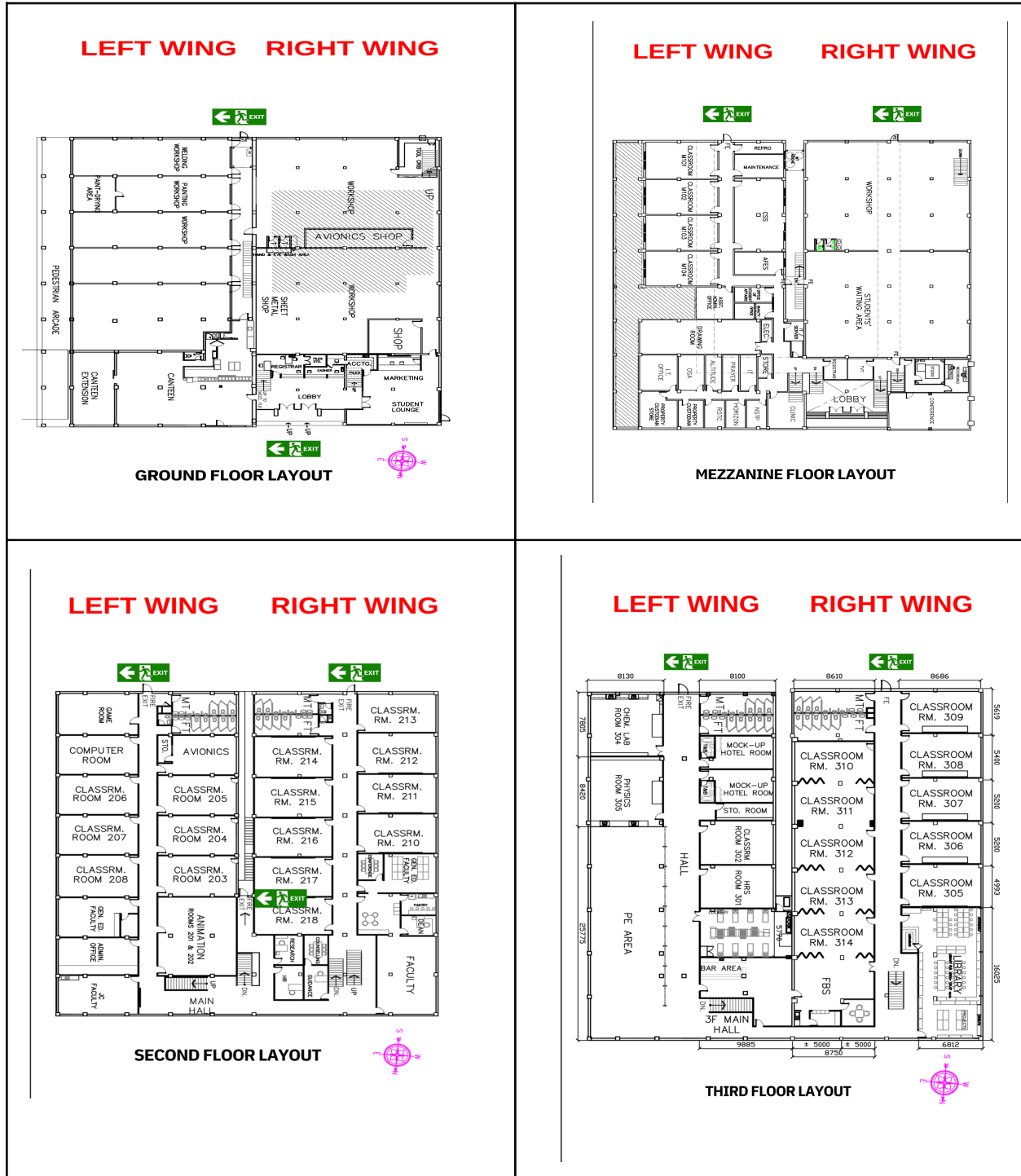

The AISAT building has a left and right wing layout. The emergency exit locations are indicated above.

## How do I know my assigned classroom and schedule?

Classrooms will be assigned per section and will be posted at <https://aisat.edu.ph/subject-scheduling/> during the start of the semester. It will be also posted in the second floor lobby area in the registrar's bulletin board.

The assigned year level, section, and class schedule will also be posted at the door of the classroom it is associated with.

## Where do I get my Certificate of Registration?

After completing the enrollment process, the registrar's office will email you a copy of your COR (Certificate of Registration) via your personal email (for **NEW** students) and AISAT assigned email (for **OLD** students). Please make sure you have your own copy to serve as proof that you are enrolled in that subject and schedule.

## What should I know about examinations?

Examination schedules will be emailed to all students a week before the examination week. It will also be posted in your virtual Google Classrooms. The registrar's office will also be posting it in their bulletin board. This consists of the time for each subject and room assignment per section.

Exams will be conducted on site, at the set schedules, and each for a duration of 2 hours, unless a longer period is required by the instructor. Please inform your instructors at least 7 days in advance for exam conflict of schedule or at least 24 hours in advance (except extreme emergencies) in case of emergencies.

Only students wearing the appropriate uniform based on the day of the schedule will be allowed to take the examination.

## When is my instructor available for consultation?

All regular instructors are available for consultation during scheduled class hours or online on weekdays from 1pm to 5pm. Part time instructors have their weekly consultation times scheduled. Students may directly chat with the faculty in the classroom, google chat or by email. Outside consultation time, instructors will reply to communications within office hours. If instructors are unresponsive, students may request for assistance from the program head or from the OSA.

## Who are the heads of the various programs?

These are the heads of the various programs. You may contact them for any academic related concerns.

Aviation OIC: Ed Vincent Ybanez

AvM OIC: Karina Ingrid Therese R. Kahulugan

IDT: Leslei Kaye Lodia-Bernaldez

[avi@aisat.edu.ph](mailto:avi@aisat.edu.ph)

[avm@aisat.edu.ph](mailto:avm@aisat.edu.ph)

[idt@aisat.edu.ph](mailto:idt@aisat.edu.ph)

## Is there an evaluation process for my instructors?

Yes, an evaluation form from the OSA will be made available after midterms for you to fill out. These will be used as a basis for feedback to your instructors after each semester. Your positive and negative feedback is valuable for continuous improvement, and you may choose to remain anonymous when submitting your response.

## When is the period for examinations?

### *First Semester*

A copy of the school calendar is posted in the AISAT website (<http://aisat.edu.ph/school-calendar/>) as well as on AISAT's FB page. In it are important dates as well as the examination dates for college in the first semester of SY 2022-2023.

Prelim Exam	: August 29 - September 1, 2023
Midterm Exam	: September 25 - September 29, 2023
Semi-Final Exam	: October 23 - October 27, 2023
Final Exam	: November 28 - December 1, 2023

### *Second Semester*

Prelim Exam	: January 29 - February 2, 2024
Midterm Exam	: February 26 - March 1, 2024
Semi-Final Exam	: April 1- April 5, 2024
Final Exam	: May 6 - April 10, 2024

The specific exam schedule for each subject will be announced by your instructors and posted in the classroom for proof of payments.

# REGISTRAR:

## First Semester

### *When is enrollment?*

First Year College Students	: January 18, 2023 to July 21, 2023
For Old Students	: June 26, 2023 to July 21, 2023

Late registration is from **July 22, 2023 to August 4, 2023**.  
Late fee of **P500** will apply.

NOTE: Students with lacking requirements will be notified and all required credentials should already be submitted by **November 10, 2023**.

### *When is adding and dropping?*

Adding and dropping may be done only from **August 1- 4, 2023**.  
This must be done in person at the Registrar's office.

### *When is the start of class?*

Classes will start on **August 1, 2023**.

## Second Semester

### *When is enrollment?*

Early Enrollment (New/Old)	: November 20, 2023 to December 14, 2023
Regular Enrollment (New/Old)	: December 27, 2023 to January 5, 2024

Late enrollment is from **January 6, 2024 to January 12, 2024**.  
Late fee of **P500** will apply.

### *When is adding and dropping?*

Adding and dropping may be done only from **January 8 - 12, 2024**.  
This must be done in person at the Registrar's office.

### *When is the start of class?*

Classes will start on **January 8, 2024**.

## How do I check my grades and account balance?

Once available, your semester grades will be posted online at <http://aisatportal.com>.

Username: Your Student ID Number

(if your AISAT email address is [54321@aisat.edu.ph](mailto:54321@aisat.edu.ph), your Student ID Number is **54321**)

Password : Birthdate (YYYY-MM-DD)

(if your birthdate is May 9, 2000, your password is **2000-05-09**)



## How do I apply for graduation?

Once you are enrolled in your final semester, fill out the graduation application form at:

<https://docs.google.com/forms/d/e/1FAIpQLSeR5HcpyRNI4jTz5Z6HOVzf-Zmd6ZwdmJfVSzTeaOaS5TyYVA/viewform>.

Your records will be evaluated as part of the screening process for the FINAL LIST of graduating students, which is done after the final grades have been checked and encoded. Thereafter, a confirmation email will be sent to you by the registrar's office.

## What is AISAT's Data Privacy Policy?

You may read AISAT's Data Privacy Policy in the student handbook available for download from the AISAT website (<http://aisat.edu.ph/student-handbook/>).



# CASHIER:

## First Semester Fees

How much is the fee for the first semester SY 2023-2024?

Full Tuition & Misc Fees								
	A	B	C	D	E	F	G	H = (C+D+E+F+G)
		1st sem No.						
	Fee/unit	Unit	Tuition Fee	Lab Fee	Misc	Intramurals	Bridging	Total Fee
<b>BSAMT</b>								
1st Year	893.26	28.5	25,457.91	8,000.00	10,544.90	650.00		44,652.81
2nd Year	842.70	29	24,438.30	10,000.00	9,841.40	650.00		44,929.70
3rd Year	795.00	17	13,515.00	2,000.00	9,461.00	650.00		25,626.00
3rd Year w/OJT	795.00	11	8,745.00	2,000.00	9,461.00	650.00		20,856.00
4th Year	773.25	17	13,145.25	2,000.00	9,226.11	650.00		25,021.36
<b>BSAET</b>								
1st Year	893.26	28.5	25,457.91	8,000.00	10,544.90	650.00		44,652.81
2nd Year	842.70	22	18,539.40	8,000.00	9,841.40	650.00		37,030.80
3rd Year	795.00	13	10,335.00		9,461.00	650.00		20,446.00
4th Year	773.25	17	13,145.25	2,000.00	9,226.11	650.00		25,021.36
<b>BSEMC (Animation)</b>								
1st Year	893.26	21.5	19,205.09	3,750.00	10,544.90	650.00		34,149.99
2nd Year	842.70	20	16,854.00	5,000.00	9,841.40	650.00		32,345.40
3rd Year	795.00	21	16,695.00	8,750.00	9,461.00	650.00		35,556.00
4th Year	773.25	12	9,279.00	5,000.00	9,226.11	650.00		24,155.11
<b>BSEMC (Game Programing)</b>								
1st Year	893.26	21.5	19,205.09	3,750.00	10,544.90	650.00		34,149.99
2nd Year	842.70	23	19,382.10	5,000.00	9,841.40	650.00		34,873.50
3rd Year	795.00	18	14,310.00	7,500.00	9,461.00	650.00		31,921.00
4th Year	773.25	12	9,279.00	5,000.00	9,226.11	650.00		24,155.11
<b>DDA</b>								
2nd Year	842.70	23	19,382.10	8,750.00	9,841.40	650.00		38,623.50
<b>BS AvM</b>								
1st Year	893.26	24.5	21,884.87	0.00	10,544.90	650.00	2,000.00	35,079.77
2nd Year	842.70	23	19,382.10	0.00	9,841.40	650.00		29,873.50
3rd Year	795.00	15	11,925.00	0.00	9,461.00	650.00		22,036.00
4th Year	773.25	6	4,639.50	0.00	6,919.58	650.00		12,209.08



## ASIAN INTERNATIONAL SCHOOL OF AERONAUTICS AND TECHNOLOGY

### Details of Fees for School Year 2023-2024 1st Semester

School Year	1st Year	2nd Year	3rd Year	4th Year
Tuition Fee Per Unit	893.26	842.70	795.00	773.25
Laboratory Fee per subject (BSAMT & BSAET)	2,000.00	2,000.00	2,000.00	2,000.00
Laboratory Fee per subject (BSEMC)	1,250.00	1,250.00	1,250.00	1,250.00
<b>Miscellaneous Fees</b>				
Registration	774.16	730.34	689.00	670.15
Library Fee	530.00	530.00	530.00	515.50
Medical Fee	714.61	674.16	636.00	618.60
Athletics Fee	595.51	561.80	530.00	515.50
Guidance Fee	595.51	561.80	530.00	515.50
Energy Fee	2,382.03	2,247.20	2,120.00	2,062.00
Internet Fee	500.00	500.00	500.00	500.00
Audio Visual	300.00	300.00	300.00	300.00
Testing Materials	595.51	561.80	530.00	515.50
Student Services	874.50	874.50	874.50	850.58
Maintenance Fee	874.50	874.50	874.50	850.58
Student Insurance	238.20	224.72	212.00	206.20
Student Handbook	237.44	224.00	212.00	206.20
School ID	297.75			
School Publication (Altitude)	285.84	269.66	254.40	247.44
Student Body Organization Membership Fee	71.47	67.42	63.60	61.86
Drug Test/X-ray	593.60	560.00	530.00	515.50
Community Extension	84.27	79.50	75.00	75.00
<b>Total</b>	<b>10,544.90</b>	<b>9,841.40</b>	<b>9,461.00</b>	<b>9,226.11</b>

**NOTE:** This **DOES NOT INCLUDE** uniforms and team funds for activities.

## Second Semester Fees

How much is the fee for the second semester SY 2023-2024?

Full Tuition & Misc Fees							
	A	B	C	D	E	F	G = (C+D+E+F)
		2nd sem					
	Fee/unit	No. Unit	Tuition Fee	Lab Fee	Misc	Pasundayag	Total Fee
<b>BSAMT</b>							
1st Year	893.26	27.50	24,564.65	8,000.00	9,177.90	220.00	41,962.55
2nd Year	842.70	26.00	21,910.20	6,000.00	8,832.68	220.00	36,962.88
3rd Year	795.00	16.00	12,720.00	2,000.00	8,507.00	220.00	23,447.00
4th Year	773.25	14.00	10,825.50	2,000.00	8,298.21	220.00	21,343.71
<b>BSAeT</b>							
1st Year	893.26	24.50	21,884.87	8,000.00	9,177.90	220.00	39,282.77
2nd Year	842.70	24.00	20,224.80	6,000.00	8,832.68	220.00	35,277.48
3rd Year	795.00	12.00	9,540.00		8,507.00	220.00	18,267.00
4th Year	773.25	17.00	13,145.25	2,000.00	8,298.21	220.00	23,663.46
<b>BSEMC (Animation)</b>							
1st Year	893.26	21.50	19,205.09	5,000.00	9,177.90	220.00	33,602.99
2nd Year	842.70	20.00	16,854.00	6,250.00	8,832.68	220.00	32,156.68
3rd Year	795.00	21.00	16,695.00	6,250.00	8,507.00	220.00	31,672.00
4th Year	773.25	9.00	6,959.25		6,223.66	220.00	13,402.91
<b>BSEMC (Game Programing)</b>							
1st Year	893.26	21.50	19,205.09	5,000.00	9,177.90	220.00	33,602.99
2nd Year	842.70	20.00	16,854.00	6,250.00	8,832.68	220.00	32,156.68
3rd Year	795.00	21.00	16,695.00	6,250.00	8,507.00	220.00	31,672.00
4th Year	773.25	9.00	6,959.25		6,223.66	220.00	13,402.91
<b>DDA</b>							
2nd Year	842.70	11.00	9,269.70	1,250.00	8,832.68	220.00	19,572.38
<b>BS AvM</b>							
1st Year	893.26	24.50	21,884.87	0.00	9,177.90	220.00	31,282.77
2nd Year	842.70	20.00	16,854.00	0.00	8,832.68	220.00	25,906.68
3rd Year	795.00	13.00	10,335.00	0.00	8,507.00	220.00	19,062.00
4th Year	773.25	6.00	4,639.50	0.00	6,223.66	220.00	11,083.16

## ASIAN INTERNATIONAL SCHOOL OF AERONAUTICS AND TECHNOLOGY

### Details of Fees for School Year 2023-2024 2ndSemester

School Year	1st Year	2nd Year	3rd Year	4th Year
Tuition Fee Per Unit	893.26	842.70	795.00	773.25
Laboratory Fee per subject (BSAMT & BSAET)	2,000.00	2,000.00	2,000.00	2,000.00
Laboratory Fee per subject (BSEMC)	1,250.00	1,250.00	1,250.00	1,250.00
<b>Miscellaneous Fees</b>				
Registration	774.16	730.34	689.00	670.15
Library Fee	530.00	530.00	530.00	515.50
Medical Fee	714.61	674.16	636.00	618.60
Athletics Fee	595.51	561.80	530.00	515.50
Guidance Fee	595.51	561.80	530.00	515.50
Energy Fee	2,382.03	2,247.20	2,120.00	2,062.00
Internet Fee	500.00	500.00	500.00	500.00
Audio Visual	300.00	300.00	300.00	300.00
Testing Materials	595.51	561.80	530.00	515.50
Student Services	874.50	874.50	874.50	850.58
Maintenance Fee	874.50	874.50	874.50	850.58
Student Insurance				
Student Handbook				
School ID				
School Publication (Altitude)	285.84	269.66	254.40	247.44
Student Body Organization Membership Fee	71.47	67.42	63.60	61.86
Drug Test/X-ray				
Community Extension	84.27	79.50	75.00	75.00
<b>Total</b>	<b>9,177.90</b>	<b>8,832.68</b>	<b>8,507.00</b>	<b>8,298.21</b>

**NOTE:** This **DOES NOT INCLUDE** uniforms and team funds for activities.

## When is my balance payable?

After payment of your down payment upon enrollment per semester, your fees are payable in 4 equal installments with the following payment schedule:

### *First Semester*

Prelim Exam	: August 25, 2023
Midterm Exam	: September 22, 2023
Semi-Final Exam	: October 20, 2023
Final Exam	: November 24, 2023

### *Second Semester*

Prelim Exam	: January 26, 2024
Midterm Exam	: February 23, 2024
Semi-Final Exam	: March 27, 2024
Final Exam	: May 3, 2024

Students who are unable to pay the installment amount on these dates should approach the OSA 3 days before the due date to explain their situation. Students who are delinquent without any reason and who do not inform the OSA 3 days before the due date will be charged a late **fee of 500 per late payment**. Please pay your fees on time, otherwise, you may not be able to complete the semester.

## How do I compute my payables?

Sample Computation for 1st Year 1st Semester BS AMT student:

Total Fee payable	: 44,652.81
Less: Downpayment**	: 6,000.00
Balance after Down Payment	: 38,652.81

Payable Amounts (Balance divided by 4) before

Aug 25, 2023	: 9,663.21
Sept 22, 2023	: 9,663.21
October 20, 2023	: 9,663.21
November 24, 2023	: 9,663.21

\*\* Downpayment for 1st and 2nd year is P6,000.

\*\* Downpayment for 3rd and 4th year is P5,000.

Avoid late payment charges by paying your fees ON time.

## How do I pay for my fees?

AISAT will only accept online payments. For payment through Palawan Express and ML Kwarto Padala, please visit <http://aisat.edu.ph/online-payment-procedure/>, otherwise, please use the information below.



**ANNOUNCEMENT**

Payment on Tuition and other School Fees will be done directly using **Metrobank** with the given details:

**Account Number: 6687668027993**  
**Account Name: AISAT Corp**

For the down payment, kindly write your name on the deposit slip, take a clear photo and send it to [cashier@aisat.edu.ph](mailto:cashier@aisat.edu.ph) as your proof of payment.

For subsequent payments (after enrollment), please post your proof of payment in the **Google Classroom "Proof of Payment"** section.

GCash thru **Bank Transfer** may also be used.

Thank you!

 AISAT Davao  [www.aisat.edu.ph](http://www.aisat.edu.ph)

## How do I inform the school of my payments?

Your initial down payment should be uploaded on the online enrollment form. All proof of payments subsequent to the down payment must be submitted to the online classroom named as "Proof of Payment. You will be invited to join the classroom via email.

## What is the cost of Uniforms?

STUDENT'S UNIFORM PRICES		
SY 2023-2024		
GENERAL UNIFORMS/OTHERS		PRICE
ROTC/CWTS Uniform		<b>280.00</b>
AISAT Jacket		<b>1,200.00</b>
Wednesday Uniform (Polo Shirt)		<b>650.00</b>
PE Uniform		<b>700.00</b>
	Jogging Pants	420.00
	PE Shirt	280.00
Shoulder Board		<b>100.00</b>
ID Sling (replacement)		<b>138.00</b>
Student ID (replacement)		<b>160.00</b>
BSAMT & BSAET		
Type A (2 sets)		<b>3,810.00</b>
	Polo (2 pcs.)	1,300.00
	Pants (2 pcs.)	1,300.00
	Nameplate	450.00
	Collar Pin	350.00
	Buckle	360.00
	Belt	50.00
Laboratory Uniform (over-all)		<b>1,500.00</b>
PPE		<b>450.00</b>
	Googles	
	Respiratory Mask	
	Ear Plug	
	Arm Sleeves	
	Gloves	
BSEMC		
Type A (2 sets)		<b>3,300.00</b>
	Polo/Blouse (2 pcs.)	1,300.00
	Skirt / Pants (2 pcs.)	1,300.00
	Nameplate	350.00
	Collar Pin	350.00

<b>BSAvM (Female)</b>		
<b>Type A (2 sets &amp; 1 vest)</b>		<b>4,600.00</b>
	Blouse (2 pcs.)	1,450.00
	Skirt (2 pcs.)	1,300.00
	Vest	750.00
	Nameplate	450.00
	Collar Pin	350.00
	Scarf	300.00
<b>Type A (2 sets &amp; 1 vest)</b>		<b>4,750.00</b>
	Blouse (2 pcs.)	1,450.00
	Trousers/Pants (2 pcs.)	1,450.00
	Vest	750.00
	Nameplate	450.00
	Collar Pin	350.00
	Scarf	300.00
<b>BSAvM (Male)</b>		
<b>Type A (2 sets &amp; 1 Blazer)</b>		<b>5,000.00</b>
	Long Sleeves (2 pcs.)	1,450.00
	Pants (2 pcs.)	1,450.00
	Blazer	1,000.00
	Nameplate	450.00
	Collar Pin	350.00
	Necktie	300.00

For questions please email [cashier@aisat.edu.ph](mailto:cashier@aisat.edu.ph)

## What is included in the Type A sets?

BSAMT & BSAET	2 POLOS, 2 PANTS, NAMEPLATE, COLLAR PIN, BELT & BUCKLE
BSEMC	2 POLO/BLOUSE, 2 PANTS, NAMEPLATE & COLLAR PIN
BSAvM - Female	2 BLOUSE, 2 SKIRTS, 1 VEST, NAMEPLATE, COLLAR PIN & SCARF
BSAvM - Male	2 LONG SLEEVES, 2 PANTS, 1 BLAZER, NAMEPLATE, COLLAR PIN ( NECKTIE)



## How do I check my account balance and grades?

Please use the online access at <http://aisatportal.com>.

Username :Your Student ID Number  
(if your AISAT email address is [54321@aisat.edu.ph](mailto:54321@aisat.edu.ph),  
your Student ID Number is **54321**)  
Password :Birthdate (YYYY-MM-DD)  
(if your birthdate is May 9, 2000,  
your password is **2000-05-09**)

For your payment and tuition fee concerns please don't hesitate to email our accounting office at [cashier@aisat.edu.ph](mailto:cashier@aisat.edu.ph)



## Will I be able to enroll if I have a pending balance from the previous semester?

No. All outstanding balances must be cleared before enrolling for the next semester. However, if you have valid reasons, you may apply for a payment extension at least 3 days before the last day (not counting late enrollment days) of enrollment by filling out the form at <https://forms.gle/VYGdWbuWTRrHEE2X7>. You will then be informed of the status of your application by the Office of the Student Affairs.

## OSA:

### When will the orientation be?

#### *First Semester*

Orientation will be conducted on **July 31, 2023**.

#### *Second Semester*

Orientation will be conducted on **January 8, 2024**.

### What scholarships are available?

- A. Student Assistance Scholarship (SAS) - See Student Handbook for details
- B. Academic Scholarships - See Student Handbook for details
- C. CHED SCHOLARSHIP
  - 1. **TES** - We don't have any TES grantees as of yet. Given the fact that these grantees are from the poorest of the poor and are part of the LISTAHANAN 2.0 from DSWD (4ps).
  - 2. **TDP-TES** - Since this is a congressional scholarship, you can apply directly to your LGU /District where you belong. They will provide a list of requirements for you to comply with, once complied with, your district will then forward your name to CHED, and CHED will evaluate your application. Once approved, your name will be posted at CHED Davao FB page. CHED will then notify the school for other requirements and the billing process.

## What information can I find on the AISAT website?

- A. School Calendar
- B. Student handbook
- C. Contact details of all personnel (email)
- D. Events and News write-ups
- E. Altitude Student Publication

## How are school announcements made?

Announcements are made through AISAT's Facebook account at "[Aisat Davao](#)" please be alert for such announcements. You may also receive announcements through your AISAT email account, or through the Google Classroom named "Proof of Payment."

## FORMS:

### Order Forms

Please use the following links to order the corresponding items. Please refer to the recommended uniform set or individual price tables above.

Order Forms	Links	Follow Up With	Processing Time	Releasing
ID Replacement	<a href="https://forms.gle/6YYPG1idp3UWHbKy5">https://forms.gle/6YYPG1idp3UWHbKy5</a>	it@aisat.edu.ph	7 working days	M - W - F 9am to noon
Uniform Order	<a href="https://forms.gle/rtowZNrE3pvf5c4b7">https://forms.gle/rtowZNrE3pvf5c4b7</a>	procurement@aisat.edu.ph	3 working days if in stock. For order basis items, please wait for our email	M - W - F 9am to noon
Credentials Order	<a href="https://docs.google.com/forms/d/e/1FAIpQLScsLUfS-YLab3IApVXj_egyzm6hhcbV7hsxLDTZQBj1yolXA/viewform">https://docs.google.com/forms/d/e/1FAIpQLScsLUfS-YLab3IApVXj_egyzm6hhcbV7hsxLDTZQBj1yolXA/viewform</a>	registrar@aisat.edu.ph	10 working days	9am to 12 noon

### Request Forms

Please fill the forms in the links for your related concerns.

Order Forms	Links	Follow Up With	Processing Time
Student Portal Concern	<a href="https://forms.gle/QdSxtZv3FuqyKxVG6">https://forms.gle/QdSxtZv3FuqyKxVG6</a>	it@aisat.edu.ph	2 working days
Google 2-Step Verification	<a href="https://forms.gle/ngTmJoKpQdXag5FC6">https://forms.gle/ngTmJoKpQdXag5FC6</a>	it@aisat.edu.ph	2 working days
Google Password Reset	<a href="https://docs.google.com/forms/d/e/1FAIpQLScO89KXsvGKQJUPdSnBZpild4ZBGGZeZqq64BzcSi7ykcQImA/viewform">https://docs.google.com/forms/d/e/1FAIpQLScO89KXsvGKQJUPdSnBZpild4ZBGGZeZqq64BzcSi7ykcQImA/viewform</a>	it@aisat.edu.ph	2 working days
Payment Extension Request (form is available upon request )	<a href="https://forms.gle/P9JniYXZdTvAE1ga6">https://forms.gle/P9JniYXZdTvAE1ga6</a>	admin@aisat.edu.ph	2 working days
Request to Open Subject (form will be available during the second semester)	<a href="https://forms.gle/CFELgZyZCwi2ZMjw7">https://forms.gle/CFELgZyZCwi2ZMjw7</a>	acad@aisat.edu.ph	

For further information, please email [helpdesk@aisat.edu.ph](mailto:helpdesk@aisat.edu.ph).

## **May I send someone to claim my requested item(s)?**

Yes, you may. Please email your authorization letter (with your signature) ahead of time to [admin@aisat.edu.ph](mailto:admin@aisat.edu.ph) and use your assigned AISAT email account when doing so. Don't forget to tell the authorized person to bring one valid ID.

## CONTACT DETAILS:

### Who can I go to for various concerns?

DESIGNATION	NAME	EMAIL	LOCAL NO. **
Aviation BS AMT and AET -	Ed Vincent Ybanez	<a href="mailto:avi@aisat.edu.ph">avi@aisat.edu.ph</a>	301
BS AvM	Karina Ingrid Therese R. Kahulugan	<a href="mailto:avm@aisat.edu.ph">avm@aisat.edu.ph</a>	N/A
BS EMC	Leslei Kaye Lodia-Bernaldez	<a href="mailto:idt@aisat.edu.ph">idt@aisat.edu.ph</a>	N/A
Administrator	Matty Joey Torres	<a href="mailto:admin@aisat.edu.ph">admin@aisat.edu.ph</a>	206
Registrar	Hazel Joy Barnes	<a href="mailto:registrar@aisat.edu.ph">registrar@aisat.edu.ph</a>	102
Cashier (payments)	Cherry Blossom Jamoner	<a href="mailto:cashier@aisat.edu.ph">cashier@aisat.edu.ph</a>	103
Office of the Student Affairs	Camelle Yu	<a href="mailto:osa@aisat.edu.ph">osa@aisat.edu.ph</a>	207
Clinic	Riz Bianca Nicole Bascon	<a href="mailto:clinic@aisat.edu.ph">clinic@aisat.edu.ph</a>	201
Guidance	Ma. Cecelia Santander	<a href="mailto:guidance@aisat.edu.ph">guidance@aisat.edu.ph</a>	306
Campus Ministry	Lorence Marimon	<a href="mailto:ministry@aisat.edu.ph">ministry@aisat.edu.ph</a>	306
Library	Roselyn Manalo	<a href="mailto:library@aisat.edu.ph">library@aisat.edu.ph</a>	401
Placement	Joahna Paula Cruz	<a href="mailto:placement@aisat.edu.ph">placement@aisat.edu.ph</a>	101
Admissions Office	Viktorria Villamor	<a href="mailto:admissions@aisat.edu.ph">admissions@aisat.edu.ph</a>	101
IT (Portal and Email issues)	Alran Eric Cifra	<a href="mailto:it@aisat.edu.ph">it@aisat.edu.ph</a>	N/A
Helpdesk - all other concerns	Viktorria Villamor	<a href="mailto:helpdesk@aisat.edu.ph">helpdesk@aisat.edu.ph</a>	101

\*\* Trunk Line Phone Number: **(082) 295-7219**

### What is the best way to communicate with other school personnel?

You may drop by their offices, or, to book an appointment, you may contact AISAT personnel through GOOGLE CHAT which is an app that you can download on your phone and use the person's email address as contact details and username. You may find the email addresses of all AISAT personnel in AISAT's website <http://aisat.edu.ph/email-list/>. You may also contact them by email. We shall strive to answer your questions within 24 hours on weekdays.